

Plastic Panels Cut to Length Service

- *Save time and money by having 80/20 cut your plastic panels*
- *Panel notching services on pages 390-393*
- *See pages 245-246 listing the plastic and Alucobond™ panels for all of your guarding and decorative panel needs*
- *Consult 80/20 for machining services not shown*



Please submit a drawing with your specifications along with your order for any specially machined panels!

Description	Service Number
Cut Plastic Panels any side < 48"	7150
Cut Plastic Panels any side > 48"	7155

Wire Panels Shearing Service

- *Allow 80/20 to cut your wire panels for a complete ready-to-assemble kit*
- *See page 247 listing the wire panels for guarding and other applications*
- *See pages 390-393 for wire panel notching services. Consult 80/20 for any special wire panel machining*



Description	Service Number
Shear Wire Panels any side < 48"	7095
Shear Wire Panels any side > 48"	7100

Panel & Wire Machining Services

Notch Corner for Extrusion Clearance

- **Notch gives clearance for perpendicularly mounted T-slotted extrusions. This service is only needed when panels are installed in T-slots.**
- **See pages 245-247 for Panels**
- **Works for plastic and wire.**

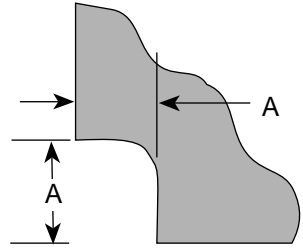

Dimension	A
10 SERIES	.312
15 SERIES	.440

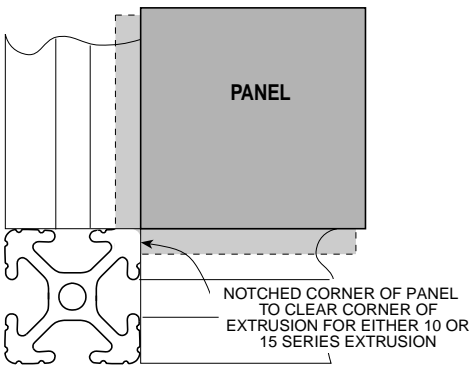

Please provide drawing of panel if not notching all corners!

Description	Service Number
Notch Panel Corner for Extrusion Clearance 10 SERIES / Notch  7504	
Notch Panel Corner for Extrusion Clearance 15 SERIES / Notch 7505	

 = 10 SERIES compatible part

Notch Corner for End Fastener Clearance

- **Notch gives clearance for end fastener. This service is only needed when panels are installed in T-slots.**
- **Works for plastic and wire.**
- **See pages 245-247 for Panels**

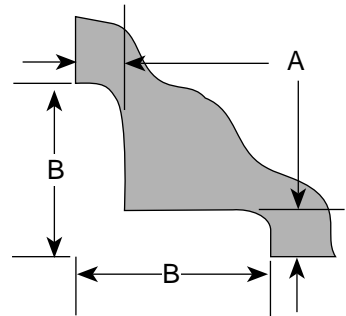

Dimension	A	B
10 SERIES	.250	.650
15 SERIES	.340	.650

Please provide drawing of panel showing location of notches!

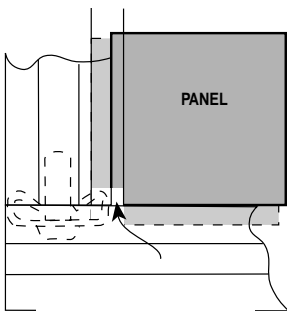

Notch Panel for End Fastener Clearance 10 and 15 SERIES

Description	Service Number
Notch Panel Corner for End Fastener 10 SERIES / Notch  7502	
Notch Panel Corner for End Fastener 15 SERIES / Notch 7503	

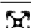
 = 10 SERIES compatible part

Panel & Wire Machining Services (Continued)

Edge Radius for Plastic Panels

- Round off sharp edges of highly visible panels
- Allows for easy insertion of panels into panel gasket, PIN 2120, on page 234
- See pages 245-246 for Plastic Panels

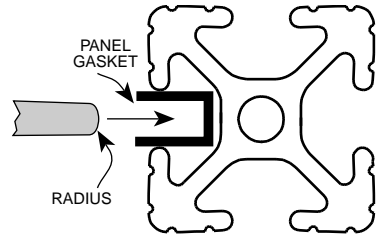

Description	Service Number
Edge Radius 3/16" or 1/4" Plastic Panels to 48" Square	7500
Edge Radius 3/16" or 1/4" Plastic Panels 48-96" Square	7501

Notch for Anchor Fastener Clearance

- Notch gives clearance for Anchor Fastener. See pages 90-91 for Anchor Fastener.
- Notch only works when panels are installed after the Anchor Fastener is tightened
- See pages 245-247 for Panels
- Works for plastic and wire.

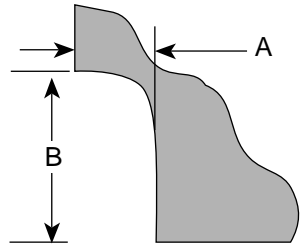

Dimension	A	B
10 SERIES	.375	1.063
15 SERIES	.500	1.750

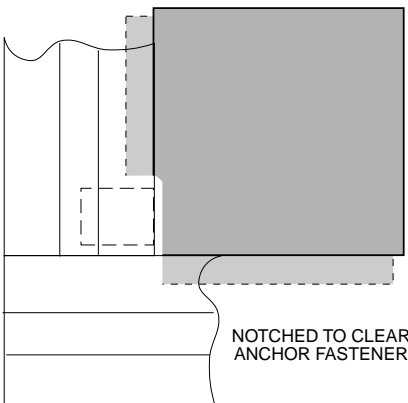

Please provide drawing of panel showing location and orientation of notches!

Description	Service Number
Notch for 10 SERIES Anchor Fastener / Notch	7311
Notch for 15 SERIES Anchor Fastener / Notch	7312

Panel and Alucobond™ Machining Services

Notch for Grabber Door Catch Clearance

- **Notch gives clearance for Grabber Door Catch. See pages 223-224 for Grabber Door Catch and mounting plate**
- **See pages 245-246 for Panels**

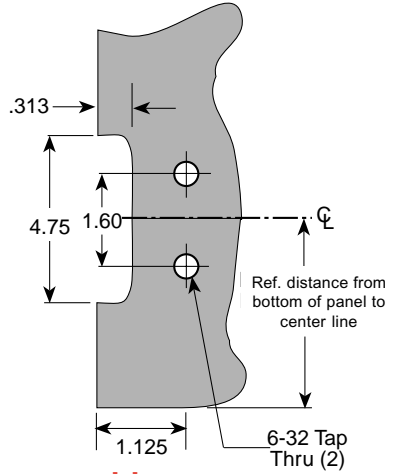

Please provide drawing of panel!

Description	Service Number
Notch and Tap Grabber Door Catch	7313

Machining Service for Grabber Handle

- **Ø2.0" hole allows for quick and easy installation of Grabber Handle on page 218**
- **See pages 245-246 for Panels**

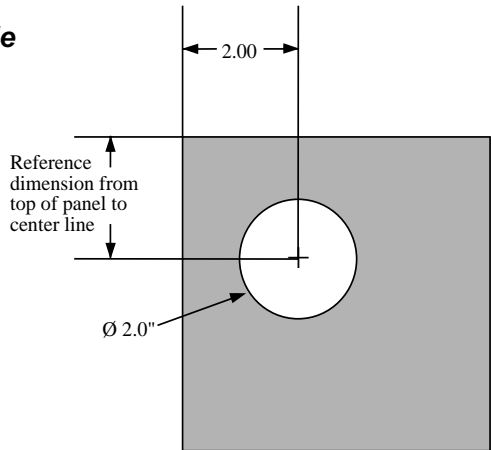

Please provide drawing of panel!

Description	Service Number
Machining Service for Grabber Handle	7510

Machining Service for Flush Handle

- **NEW!** service allows for quick and easy installation of Flush Handle on page 216.
- See pages 245-246 for Panels



Please provide drawing of panel!

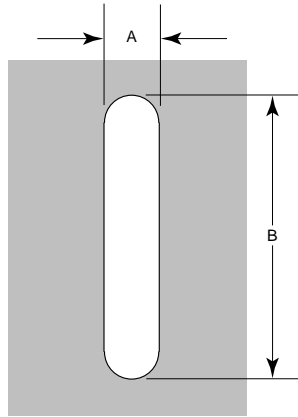

Description	Service Number
Machining Service for Small Flush Handle	7520
Machining Service for Medium Flush Handle	7521

	A	B
Small Handle	.625	3.00
Medium Handle	.625	3.90

Notch Corner for Tri-Corner Clearance

- Notch gives clearance for Tri-Corner connector. This service is only needed when panels are installed in T-slots.
- See pages 112 and 150 for Tri-Corners
- See pages 245-246 for panels
- Works for plastic and wire.

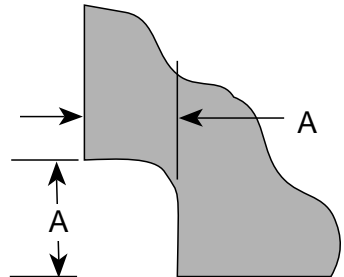

Dimension	A
10 SERIES	.337
15 SERIES	.495

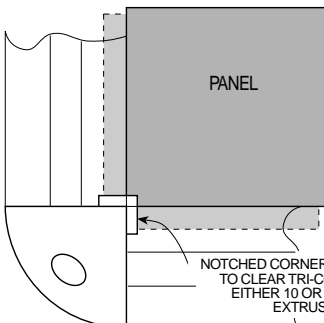



Please provide drawing of panel showing location of notches!

Description	Service Number
Notch Panel Corner for Tri-Corner 10 SERIES / Notch	7515
Notch Panel Corner for Tri-Corner 15 SERIES / Notch	7516

Panel Machining Services

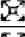
Hinge, Handle, Catch, and Retainer Mounting

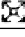
Calling out these service numbers...		...when mounting these parts to a plastic panel...	...gives you the following machine details in your panel.			
SERVICE NO.	PART NO. / DESCRIPTION	TOP OF PANEL TO CENTERLINE	EDGE OF PANEL TO CENTERLINE	HOLE SPACING	HOLE DIAMETER	
7580	2080 15 Series Adj. Hinge	3"+/- .06	0.688+/- .02	1.88+/- .02	0.375+/- .015	
7581 	2081 10 Series Adj. Hinge	3"+/- .06	0.438+/- .02	1.25+/- .02	0.313+/- .015	
7582 	2071 10 Series Detent Hinge	3"+/- .06	0.690+/- .02	1.25+/- .02	0.188+/- .015	
7583	2091 15 Series Detent Hinge	3"+/- .06	0.440+/- .02	1.34+/- .02	0.25+/- .015	
7584	2060 Plastic Handle - Large	Center Line	0.125+/- .02	7.05+/- .02	0.375+/- .015	
7585	2061 Plastic Handle - Medium	Center Line	0.125+/- .02	4.60+/- .02	0.375+/- .015	
7586	2062 Plastic Handle - Small	Center Line	0.125+/- .02	3.678+/- .02	0.313+/- .015	
7587	2070 Steel C-Handle	Center Line	1.0+/- .02	4.60+/- .02	0.375+/- .015	
7510	2730 Locking Grabber Handle	Open	2.0+/- .02	N/A	2.0+/- .015	
7520	2056 Flush Handle - Small	Open	Open	N/A	.625 x 3.0 slot	
7521	2058 Flush Handle - Medium	Open	Open	N/A	.625 x 3.9 slot	
7593 	2496/2512 1" Panel Retainer	Open	0.858+/- .02	N/A	0.313+/- .015	
7594 	2497/2513 2" Panel Retainer	Open	0.858+/- .02	N/A	0.313+/- .015	
7595	2434/2515 1.5" Panel Retainer	Open	1.28+/- .02	N/A	0.375+/- .015	
7596	2433/2516 3" Panel Retainer	Open	1.28+/- .02	N/A	0.375+/- .015	

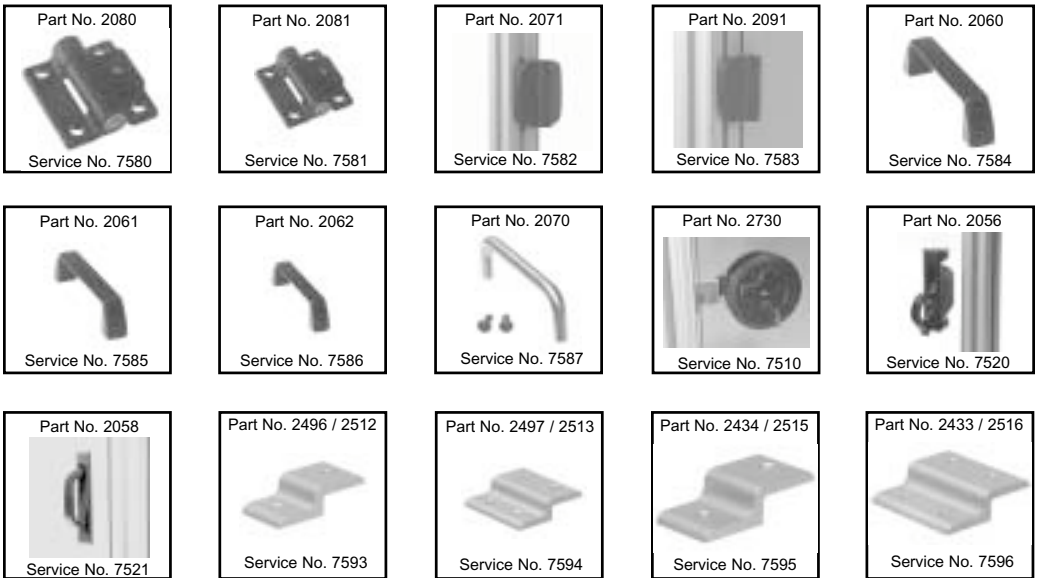

Please submit a drawing with your specifications along with your order for any specially machined panels!

See page 395 for panel drawing guidelines.

Plastic Panel Drawing Guidelines

The drawing below will aid in producing your panel drawing(s). Panel dimensions and the hinges, handles, latches, and panel retainers shown on page 394 can be specified.

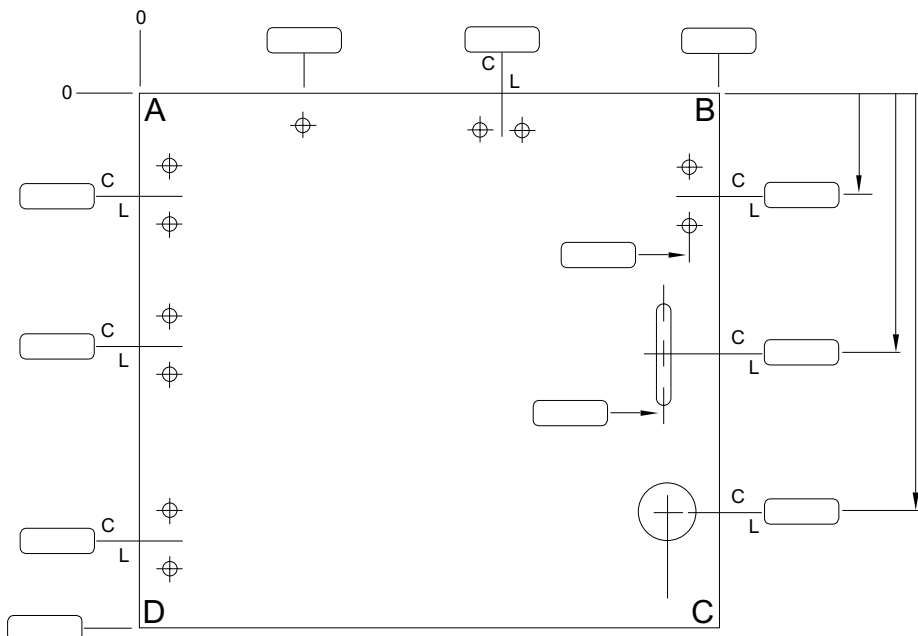

Go to (www.8020.net/PDFfiles/PlasticDrawings.pdf) to download the drawing above.

Hinges – left side of drawing

This Service No.	Mount this P/N
7580.....	2080
7581.....	2081
7582.....	2071
7583.....	2091

Handles – right side of drawing

This Service No.	Mount this P/N
7584.....	2060
7585.....	2061
7586.....	2062
7587.....	2070
7510.....	2730
7520.....	2056
7521.....	2058

Panel retainers – top of drawing

This Service No.	Mount this P/N
7593.....	2496 / 2412
7594.....	2497 / 2513
7595.....	2434 / 2515
7596.....	2433 / 2516

Please DO NOT chain dimension your drawing.

Other Plastic Panel Machining Services

- 7150 – Cut Panel ≤ 48" any side
- 7155 – Cut Panel > 48" any side
- ☒ 7502 / 7503 – Notch Corner for End Fastener Clearance – see page 390
- ☒ 7504 / 7505 – Notch Corner for Extrusion Clearance – see page 390
- ☒ 7311 / 7312 – Notch Corner for Anchor Fastener Clearance – see page 391
- ☒ 7515 / 7516 – Notch Corner for Tri-Corner Clearance – see page 393

Bi-Fold Door Application Examples

for Sliding Door Glide See Page 227

1010
Bi-Fold
Door

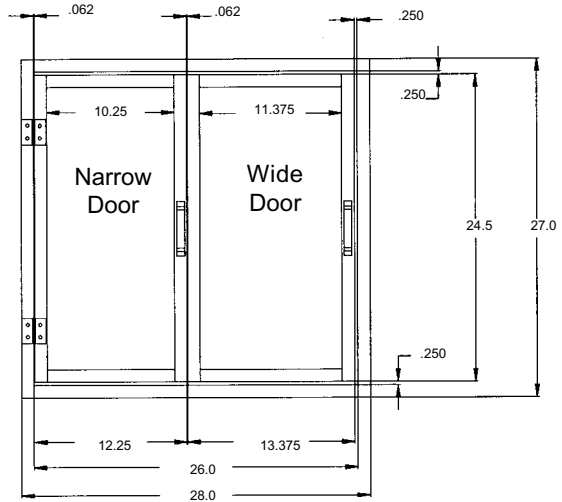
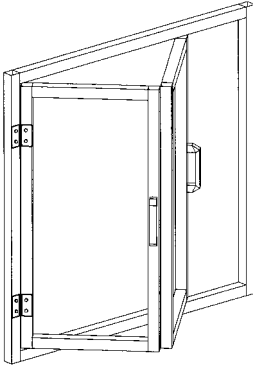

For 2086 Aluminum Hinge or 2066 Heavy Duty Hinge

To determine the width of the narrow door: Subtract the sum of the door gaps and 1.125" from the frame's inside dimension then divide by 2.

$$\text{EX: } \frac{26 - (.062 + .062 + .250 + 1.125)}{2} = 12.25$$

To determine the width of the wide door: Add 1.125" to the width of the short door.

$$\text{EX: } 12.25 + 1.125 = 13.375$$

1515/1515 Lite
Bi-Fold Door

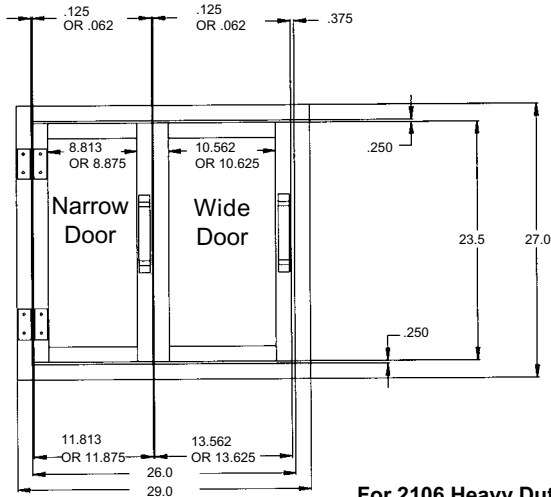
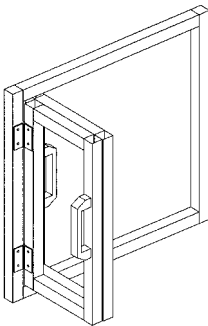

For 2085 Aluminum Hinge

To determine the width of the narrow door: Subtract the sum of the door gaps and 1.75" from the frame's inside dimension then divide by 2.

$$\text{EX: } \frac{26 - (.125 + .125 + .375 + 1.75)}{2} = 11.813$$

To determine the width of the wide door:

Add 1.75" to the width of the short door.

$$\text{EX: } 11.813 + 1.75 = 13.563$$

For 2106 Heavy Duty Hinge

To determine the width of the narrow door: Subtract the sum of the door gaps and 1.75" from the frame's inside dimension then divide by 2.

$$\text{EX: } \frac{26 - (.062 + .062 + .375 + 1.75)}{2} = 11.875$$

To determine the width of the wide door:

Add 1.75" to the width of the short door.

$$\text{EX: } 11.875 + 1.75 = 13.625$$